

PREMIUM LIST



MIDWEST COURSING CLUB

All Breed ASFA Sanctioned Lure Field Trial

Region 6

Saturday and Sunday September 27/28, 2025

Greater Racine Kennel Club

6320 Hwy G (Six Mile Rd)

Caledonia, WI

PayPal will be accepted, see next page for conditions of entry.

Day of Trial entries close promptly at 8:00 AM at the trial Secretary Table

Early Entry Fee (closes September 24, 2025): \$20.00 per hound

Day-Of-Trial Entry Fee: \$30 per Hound

Day of Trial entries close promptly at 7:30 AM at the trial Secretary Table

TRIAL HOURS: 6:00 AM each day until one hour past the completion of the last scored course of the day.

ROLL CALL AND INSPECTION: 8:00 AM (Earlier for Field Committee)

All times are Central Daylight Time.

Hounds not present at roll call will be marked absent and are not eligible for refund of entry fee.

Permission has been granted by the American Sighthound Field Association for this event under American Sighthound Field Association Rules and Regulations.

Samantha Duryee

ASFA Scheduling Committee

MWCC OFFICERS AND DIRECTORS

President: Deborah Habian

Secretary: Ann Montez

Vice-President: Kevin Carlson

Treasurer: Greg Breitbach

Board of Directors: Frank Humpal, Tara Ragatz, Clayton Montez, Christine Bernstein, DVM

JUDGES & ASSIGNMENTS

Gregory Breitbach, Milwaukee, WI

Kevin Carlson, Racine, WI

Kay Nierengarten, Saginaw, MN

Karla Schreiber, Chicago, IL

S = Single Judge * = Provisional Judge # = Canadian Judge

Saturday	A	Az	Ba	B	C	G	Ib	IG	IW	Prv	P	RR	S	SD	SL	SW	Sng	W	LCI
Gregory Breitbach	S	S					X									X	S	S	
Kay Nierengarten			S	S	S	S	X	S	S	S	S	S	S	S	S	X			S

Sunday	A	Az	Ba	B	C	G	Ib	IG	IW	Prv	P	RR	S	SD	SL	SW	Sng	W	LCI
Gregory Breitbach								S	S						S	X		X	
Kevin Carlson																	S		
Kay Nierengarten	S	S	X	X	X	X	X				X	X	X			X			
Karla Schreiber						*	*			S	*	*	*					*	S

Running Order Sat	PH	GH	SD	AH	AZ	BZ	WH	IG	IW	SW	SL	Ba	RR	Sng	Ib	LCI	CI	Prv	SA
-------------------	----	----	----	----	----	----	----	----	----	----	----	----	----	-----	----	-----	----	-----	----

Running Order Sun	PH	GH	AH	BZ	WH	RR	Ib	SD	AZ	IG	Ba	LCI	CI	Prv	IW	SW	SL	SA	Sng
-------------------	----	----	----	----	----	----	----	----	----	----	----	-----	----	-----	----	----	----	----	-----

Note: If running order is changed on day of trial due to workers or conditions, a new order will be posted.

FIELD COMMITTEE

Field Trial Chairman	Gregory Breitbach
Field Trial Secretary	Karen Breitbach, 1930 W Galena St, Milwaukee, WI 53205, 414-344-2276 foolishhound@gmail.com
Lure Operators	Gregory Breitbach, Kevin Carlson, Frank Humpal

RIBBONS

First Place - Blue;

Third Place - Yellow;

NBQ - Dark Green.

Best of Breed - Purple & Gold

Best in Field – will be offered both days

Second Place - Red;

Fourth Place - White;

High Scoring Singles – Navy Blue & Gold

BIF – Red White & Blue

Mail Entries to:

Karen Breitbach, 1930 W Galena St, Milwaukee, WI 53205

Entries will not automatically be acknowledged. If you want confirmation an entry is received, please include a valid email address or send request to FTS at foolishhound@gmail.com prior to 3:00 pm September 24, 2025.

PayPal for Early Entries accepted! Go to www.midwestcoursing.homestead.com

IMPORTANT Early Entry PAYPAL RULES!!!!

YOU **MUST** Email the FTS the following entry information at foolishhound@gmail.com no later than 3:00 pm Sep 23, 2020:

- *Breed,
- *Call Name
- *Registration Number
- *Stake Entered
- *Days Entered
- *Your Name and Phone Number.

Failure to do this will result in **DAY OF TRIAL FEES!!!!!!**

YOU **MUST** bring the **HARD COPY** Entry Form for each entry each day to the Trial. **ASFA requirement.**

MWCC adds \$2 to each PayPal entry to cover PayPal fees.

Late, incomplete, unsigned, or UNPAID entries will NOT be accepted.

Make check payable to "**MWCC**".

Substitutes for lame or in-season hounds are allowed if substitute has same owner and the Field Secretary is notified by 8:00 AM the day of the trial.

ELIGIBLE BREEDS & REGISTRY

Only purebred Afghan Hounds, Azawakhs, Basenjis, Borzoi, Cirneco dell'Etna, Greyhounds, Ibizan Hounds, Irish Wolfhounds, Italian Greyhounds, Pharaoh Hounds, Rhodesian Ridgebacks, Salukis, Scottish Deerhounds, Silken Windhound, Sloughis, and Whippets. Provisional breeds may be entered in the regular stakes. Current Provisional breeds include purebred Chart Polski, Galgo Español, Magyar Agar, Peruvian Inca Orchid, Portuguese Podengo (Pequeno), Portuguese Podengo (Medio & Grande), and must be individually registered with the appropriate registry.

All entries shall be individually registered with the AKC (ILP/PAL included), the NGA, the UKC, the FCI, an ASFA-recognized foreign or ASFA Board approved registry or possess a CRN from the SPDBS. A photocopy of acceptable registry must be submitted with each hound's first ASFA field trial entry; this requirement is waived for hounds registered with the NGA.

STAKES OFFERED

OPEN STAKE: Any eligible sighthound, excluding ASFA Field Champions of record. Must possess certification form signed prior to the close of entries

FIELD CHAMPION STAKE: Any ASFA Field Champion

VETERAN STAKE: Any eligible hound whose age is at least six years, except IWs whose age shall be at least five years, and Afghan Hounds, Ibizan Hounds, Rhodesian Ridgebacks, Saluki and Whippets whose age shall be at least seven years. Points & placements go toward VFCh and VLCH titles

PROVISIONAL STAKE: Any eligible sighthound of a Provisional breed that has met certification requirements. Not eligible to compete in Best of Breed or Best in Field.

SINGLES STAKE: Any eligible sighthound including those disqualified to run in other stakes. Each hound runs alone. Not eligible for Best of Breed or Best in Field. Hounds are eligible to earn TCP and CPX titles from the Singles stake. Provisional breeds are not eligible for these titles.

Lure Chasing Instinct (LCI) STAKE: Open to NON sighthounds and sighthound mixes. All entries shall be individually registered with the AKC (including ILP & PAL) or the UKC. A photocopy of acceptable registry must be submitted with each dog's first ASFA field trial entry. Dogs without a recognized registry number may obtain an ASFA ID number for a \$10 registration fee at time of entry.

Small Open: for dogs 17-1/2 inches or less at the withers and / or brachycephalic ("flat-faced") dogs who have not achieved the title of LCC.

Small Excellent: for dogs 17-1/2 inches or less at the withers and/or brachycephalic dogs who have achieved the title of LCC.

Small Veteran: for dogs 17-1/2 inches or less at the withers and/or brachycephalic dogs over the age of 7 years.

Large Open: for dogs over 17-1/2 inches at the withers who have not achieved the title of LCC.

Large Excellent: is for dogs over 17-1/2 inches at the withers who have achieved the title of LCC.

Large Veteran: for dogs over 17-1/2 inches at the withers who are over the age of 7 years.

Sighthound Mix Open: for dogs with a sighthound breed in its background who have not achieved the title of LCC.

Sighthound Mix Excellent for dogs with sighthound breed in its background who have achieved the title of LCC.

Sighthound Mix Veteran: for dogs with sighthound breed in its background over the age of 7 years. When running as a stake within a regular ASFA trial, Small will run 50% of the ASFA course as laid out for the sighthounds up to a maximum of 400 yards. All other stakes will run the full ASFA laid out course length.

SPECIAL NOTES

- All entries must be one year or older on the day of the trial.
- Stakes will be split into flights by public random draw if the entry in any regular stake is 20 or more.
- Bitches in season, lame hounds and hounds with breed disqualifications will be excused at roll call.
- Spayed, neutered, monorchid or cryptorchid hounds without breed disqualifications may be entered.
- Hounds with breed disqualifications are not eligible to enter except in the Single Stake.
- Hounds not present at the time of roll call will be scratched
- All hounds will run twice, in trios if possible or braces (except in the Single and LCI Stake), unless excused, dismissed or disqualified.
- Muzzles are not required. It is the responsibility of the owner to determine if their hound needs to be muzzled.
- Lure machine is gas powered, continuous loop. Battery back up equipment is available.
- Lure will consist of highly visible plastic strips.
- There will be a \$5 fine for any loose hound on the field that is not part of the course in progress.
- There will be a \$31 fee assessed for any returned checks
- Course will be reversed for finals and again for run-offs and Best of Breed.
- **Checks must be in U.S. Funds drawn on U.S. Banks.**
- **MWCC assumes no liability for injury to any hound or person, before, during or after the trial.**
- No alcoholic beverages allowed on the site.
- **Cell phone number at the field the day of the trial: 414-702-2276**

VETERINARIAN ON CALL

Racine WVRC **OR** WI Veterinary Referral Center
4333 Old Green Bay Road 360 Bluemound Road, Waukesha, WI
262-553-9223 262- 542- 3241

OPEN 24 hours Emergency

HOUD CERTIFICATION

Certification: Except those entering in Singles. Any entry marked **First Time Entered** must present a completed ASFA hound certification or AKC QC form to the Field Secretary BEFORE entries close. See page 6 for certification forms and make extra copies if needed. Certification runs will be offered at a cost of \$5.00 per run on after the completion of the trial. It is the responsibility of the entrant to find another hound of the same breed or similar running style to run with his/her hound for the certification. A sign-up sheet will be available on the day of the trial.

Practice: Practice and Certification will be offered Saturday only.

MOTELS AND CAMPGROUNDS

Value Inn, Oak Creek, WI, 9420 S 20th St, (off I -94 and Ryan Road), 414-761-3807

Red Roof Inn: 6360 S 13th St, Oak Creek, WI, Phone:1-800-733-7663

LaQuinta Inn Airport: 7141 South 13th St, Oak Creek, WI 53154

Phone: 1-414-762-2266

LaQuinta Inn: 7540 118th Ave, Pleasant Prairie, WI 53158 Phone: 1-262-857-7911

Red Roof Inn Milwaukee Airport: 6360 South 13TH Street Oak Creek, WI 53154 414-764-350

Super 8: 1150 Oakes Rd, Racine, WI 262-884-0486

Cliffside County Park Campgrounds: 7320 Michna Rd, Racine, WI 262-639-3385

Jellystone Park Camping Resort: 8425 Hwy 38 Caledonia, WI 262-835-2565

Sanders Park & Campground: 4809 Wood Rd, Mt Pleasant, WI 53403, 262-886-8440 (Primitive camping)

There is no camping allowed on the trial site due to city ordinance.

Conditions change, verify with hotel about pet accommodations.

LUNCH: Will be available based on COVID restrictions.

SITE AND DIRECTIONS

The Greater Racine Kennel Club grounds are not fenced but are set well off the road and has natural boundaries of trees and tall grass. Well water is available. Bring your own shade.

Address is 6320 Hwy G, Caledonia, WI

GPS coordinates:N42.81486 W087.85709

The Kennel Club is 15 miles south of Milwaukee.

I-94 North exit at Hwy G (exit 326) and go East on G. It will wind and become six-mile road.

I-94 South exit at Seven Mile Road (exit 327) turn left (East) to Hwy 38 (traffic light) and turn right (South). The road will wind and become six-mile road.

The Kennel Club is on the north side of the road with a wooden "GRKC" at the end of the driveway. Follow trial signs.

Due to local ordinance, no camping at the site.

Go to www.ASFA.org for the latest Rulebook, Policies, Contacts, Clubs, Trial Schedules, Trial Results & more

Course Plans

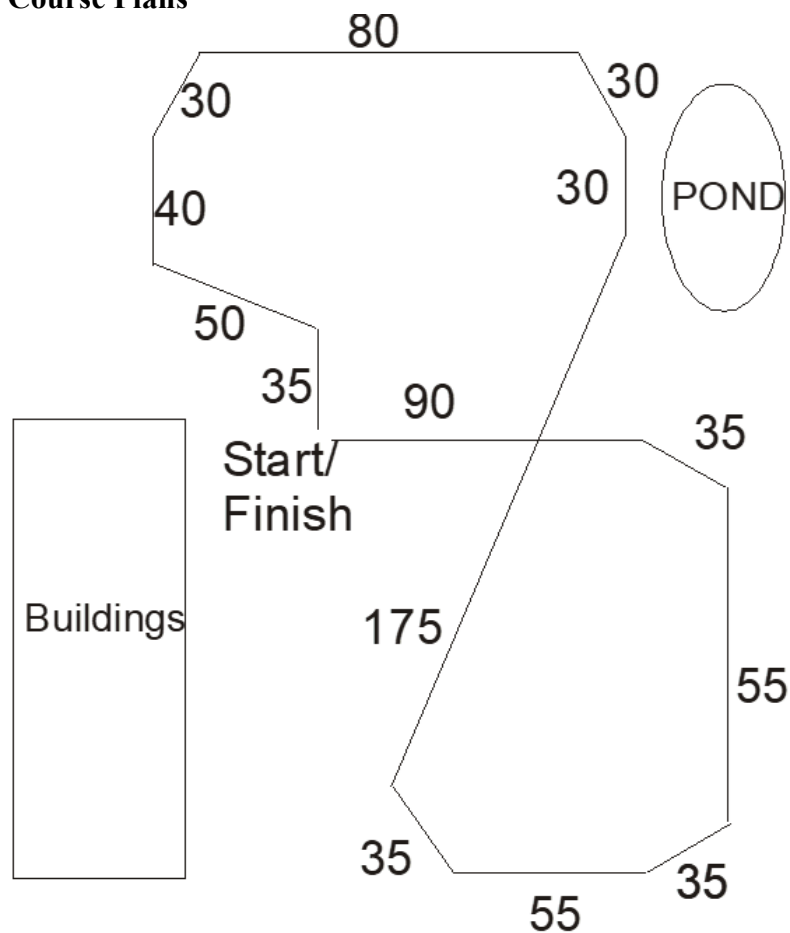

Saturday 775 yards

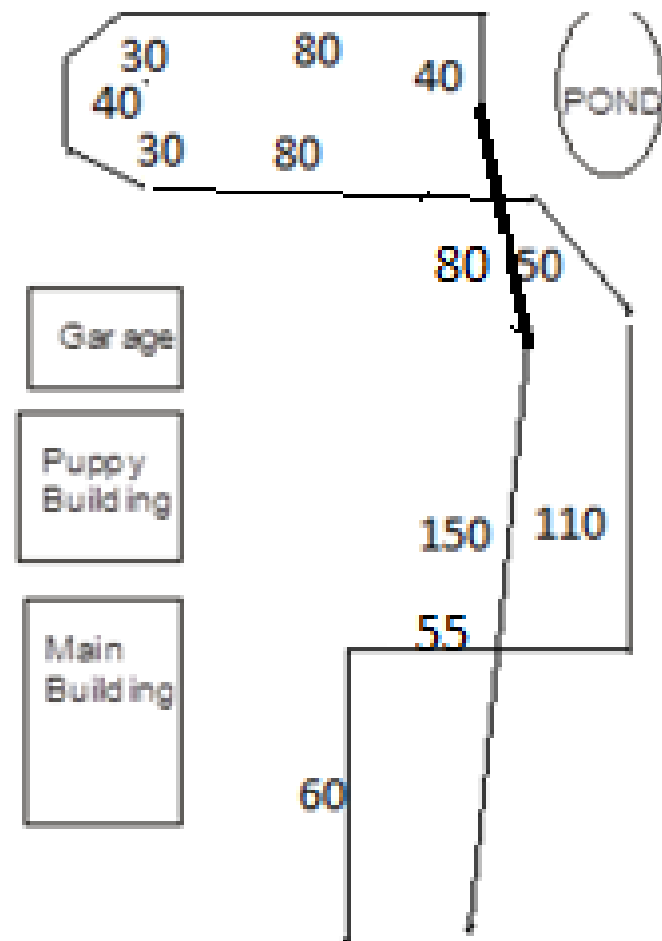

Sunday – 815 yards

The club reserves the right to alter the course diagram as required by weather and/or field conditions on the day of the trial

OFFICIAL AMERICAN SIGHTHOUND FIELD ASSOCIATION ENTRY FORM

Midwest Coursing Club

September 27, 2025

Early entries: \$20 each hound

Early entries close Wed., Sep 24, 2025 Day of Trial entries close 8:00AM

Day of Trial entry: \$30 per entry

Make Check payable in US funds to: MWCC

Mail entries to: Karen Breitbach, 1930 W Galena St, Milwaukee, WI 53205

Fee Paid _____ The Field Secretary cannot accept conditional, unsigned, incomplete or unpaid entries; please check your completed entry carefully..

Breed:	Call Name:		
Registered Name of Hound:			
Stake: <input type="checkbox"/> Open <input type="checkbox"/> FCH <input type="checkbox"/> Veteran <input type="checkbox"/> Single <input type="checkbox"/> Provisional		Additional Stakes <input type="checkbox"/> Kennel <input type="checkbox"/> Breeder <input type="checkbox"/> Bench	
Registration Number: (please write in registering body before number)			
<input type="checkbox"/> If possible, please separate my hounds	Date of Birth:	Sex: <input type="checkbox"/> Dog <input type="checkbox"/> Bitch	
Name of actual owner(s):			
Address:		Phone:	
City:	State:	Zip:	
E-mail (Optional)		(Optional) Region of Residence:	
Emergency Contact Name and Phone (Optional)			
<input type="checkbox"/> Check if this is the first ASFA trial for this hound. Attach a Hound Certification or waiver if entered in Open, Veterans, Provisional.			
<input type="checkbox"/> Check if this is a first-time entry, a copy of the official Registration of this hound must accompany this entry unless NGA.			
<input type="checkbox"/> Check if any information has changed since the last ASFA trial entry. Regarding _____			
<input type="checkbox"/> Check if this hound has been dismissed within the last 6 trials entered. Must be marked in order to qualify for a "clean" trial requirement.			

I CERTIFY that I am the actual owner of this dog, or that I am the duly authorized agent of the actual owner whose name I have entered above. In consideration of the acceptance of this entry and the opportunity to have this dog judged and to win prize money, ribbons, or trophies, I (we) agree to abide by the rules and regulations of the American Sighthound Field Association in effect at the time of this lure field trial, and by any additional rules and regulations appearing in the premium list for this lure field trial. I (we) agree that the club holding this lure field trial has the right to refuse this entry for cause, which the club shall deem to be sufficient. I (we) agree to hold this club, its members, directors, governors, officers, agents or other functionaries, any employees of the aforementioned parties and the owner(s) of the trial premises or grounds harmless from any claim for loss or injury which may be alleged to have been caused directly or indirectly to any person or thing by the act of this dog while in or upon the lure field trial premises or grounds or near any entrance thereto and I (we) personally assume all responsibility and liability for any such claim, and I (we) further agree to hold the aforementioned parties harmless from any claim loss of this dog by disappearance, theft damage or injury be caused or alleged to be caused by the negligence of the club or any of the aforementioned parties or by the negligence of any person or any other cause or causes. I (we) certify and represent that the dog entered is not a hazard to person or other dogs. This entry is submitted for acceptance of the forgoing representations and agreements.

SIGNATURE of owner or his agent
duly authorized to make this entry _____

Please separate the entries before submitting to FTS.

OFFICIAL AMERICAN SIGHTHOUND FIELD ASSOCIATION ENTRY FORM

Midwest Coursing Club

September 28, 2025

Early entries: \$20 each hound

Day of Trial entry: \$25 per entry

Early entries close Wed., September 24, 2025 Day of Trial entries close 8:00AM

Make Check payable in US funds to: MWCC

Mail entries to: Karen Breitbach, 1930 W Galena St, Milwaukee, WI 53205

Fee Paid _____ The Field Secretary cannot accept conditional, unsigned, incomplete or unpaid entries; please check your completed entry carefully.

Breed:	Call Name:		
Registered Name of Hound:			
Stake: <input type="checkbox"/> Open <input type="checkbox"/> FCH <input type="checkbox"/> Veteran <input type="checkbox"/> Single <input type="checkbox"/> Provisional		Additional Stakes <input type="checkbox"/> Kennel <input type="checkbox"/> Breeder <input type="checkbox"/> Bench	
Registration Number: (please write in registering body before number)			
<input type="checkbox"/> If possible, please separate my hounds	Date of Birth:	Sex: <input type="checkbox"/> Dog <input type="checkbox"/> Bitch	
Name of actual owner(s):			
Address:		Phone:	
City:	State:	Zip:	
E-mail (Optional)		(Optional) Region of Residence:	
Emergency Contact Name and Phone (Optional)			
<input type="checkbox"/> Check if this is the first ASFA trial for this hound. Attach a Hound Certification or waiver if entered in Open, Veterans, Provisional.			
<input type="checkbox"/> Check if this is a first-time entry, a copy of the official Registration of this hound must accompany this entry unless NGA.			
<input type="checkbox"/> Check if any information has changed since the last ASFA trial entry. Regarding _____			
<input type="checkbox"/> Check if this hound has been dismissed within the last 6 trials entered. Must be marked in order to qualify for a "clean" trial requirement.			

I CERTIFY that I am the actual owner of this dog, or that I am the duly authorized agent of the actual owner whose name I have entered above. In consideration of the acceptance of this entry and the opportunity to have this dog judged and to win prize money, ribbons, or trophies, I (we) agree to abide by the rules and regulations of the American Sighthound Field Association in effect at the time of this lure field trial, and by any additional rules and regulations appearing in the premium list for this lure field trial. I (we) agree that the club holding this lure field trial has the right to refuse this entry for cause, which the club shall deem to be sufficient. I (we) agree to hold this club, its members, directors, governors, officers, agents or other functionaries, any employees of the aforementioned parties and the owner(s) of the trial premises or grounds harmless from any claim for loss or injury which may be alleged to have been caused directly or indirectly to any person or thing by the act of this dog while in or upon the lure field trial premises or grounds or near any entrance thereto and I (we) personally assume all responsibility and liability for any such claim, and I (we) further agree to hold the aforementioned parties harmless from any claim loss of this dog by disappearance, theft damage or injury be caused or alleged to be caused by the negligence of the club or any of the aforementioned parties or by the negligence of any person or any other cause or causes. I (we) certify and represent that the dog entered is not a hazard to person or other dogs. This entry is submitted for acceptance of the forgoing representations and agreements.

SIGNATURE of owner or his agent
duly authorized to make this entry _____

Please separate the entries before submitting to FTS.

**AMERICAN SIGHTHOUND FIELD ASSOCIATION
HOUND CERTIFICATION**

Rule effective October 1, 1994: Ch. V, Sec. 4 (a) OPEN STAKE: *To be eligible to enter the open stake, a hound must have been certified by a licensed judge within the year preceding the closing date for the entry or have previously competed in the Open Stake.* This eligibility requirement also applies to a hound entered in the Veteran Stake, which has not competed in Open previously. Please complete this portion of this form and attach it to the entry form for the hound's first entry, including an entry for a Fun Trial.

Registered Name of Hound: _____

Registration Number: _____ Breed: _____

Registered Owner's Name: _____

I hereby certify that on (date) _____, the above named hound completed a lure course of at least 500 yards, running with another hound of the same breed (or another breed with a similar running style). During the course the above named hound showed no inclination to interfere with the other hound. I further certify that I am a licensed judge for the ASFA.

Name of Licensed Judge: _____

Signature: _____ Date: _____

I hereby certify that the hound running in the certification course is the hound identified above and that information provided on this form is true and correct.

Signature: _____ Date: _____

Owner or Authorized Agent of Hound

This certification form must be attached to the entry form the first time this hound is entered in an open or veteran stake. Any hound entered in open, or veteran (as a first time entered hound), which has not been certified, shall be declared ineligible by the records coordinator and shall forfeit any points and placements awarded.

PLEASE RETAIN A COPY FOR YOUR RECORDS.

**AMERICAN SIGHTHOUND FIELD ASSOCIATION
HOUND CERTIFICATION WAIVER**

Waiver of Requirement: *This requirement will be waived for a hound that has earned a lure coursing title from another recognized organization, if such title requires competition, and if a waiver for such title has been approved by the ASFA, or a CKC Hound Certification Form.* If your hound qualifies for a waiver, complete this portion of this form and attach it to your entry form. Proof of waivers must accompany this certification form.

Registered Name of Hound: _____

Registration Number: _____ Breed: _____

Registered Owner's Name: _____

CKC: FCH FCHX

AKC: QC SC FC

Hound Certification previously submitted.

I hereby certify that the hound identified above has completed the requirements for the title indicated above (or that the required Certification was previously submitted) and that the information provided on this form is true and correct.

Signature: _____ Date: _____

Owner or Authorized Agent of Hound

**AMERICAN SIGHTHOUND FIELD ASSOCIATION
HOUND CERTIFICATION**

Rule effective October 1, 1994: Ch. V, Sec. 4 (a) OPEN STAKE: *To be eligible to enter the open stake, a hound must have been certified by a licensed judge within the year preceding the closing date for the entry or have previously competed in the Open Stake.* This eligibility requirement also applies to a hound entered in the Veteran Stake, which has not competed in Open previously. Please complete this portion of this form and attach it to the entry form for the hound's first entry, including an entry for a Fun Trial.

Registered Name of Hound: _____

Registration Number: _____ Breed: _____

Registered Owner's Name: _____

I hereby certify that on (date) _____, the above named hound completed a lure course of at least 500 yards, running with another hound of the same breed (or another breed with a similar running style). During the course the above named hound showed no inclination to interfere with the other hound. I further certify that I am a licensed judge for the ASFA.

Name of Licensed Judge: _____

Signature: _____ Date: _____

I hereby certify that the hound running in the certification course is the hound identified above and that information provided on this form is true and correct.

Signature: _____ Date: _____

Owner or Authorized Agent of Hound

This certification form must be attached to the entry form the first time this hound is entered in an open or veteran stake. Any hound entered in open, or veteran (as a first time entered hound), which has not been certified, shall be declared ineligible by the records coordinator and shall forfeit any points and placements awarded.

PLEASE RETAIN A COPY FOR YOUR RECORDS.

**AMERICAN SIGHTHOUND FIELD ASSOCIATION
HOUND CERTIFICATION WAIVER**

Waiver of Requirement: *This requirement will be waived for a hound that has earned a lure coursing title from another recognized organization, if such title requires competition, and if a waiver for such title has been approved by the ASFA, or a CKC Hound Certification Form.* If your hound qualifies for a waiver, complete this portion of this form and attach it to your entry form. Proof of waivers must accompany this certification form.

Registered Name of Hound: _____

Registration Number: _____ Breed: _____

Registered Owner's Name: _____

CKC: FCH FCHX

AKC: QC SC FC

Hound Certification previously submitted.

I hereby certify that the hound identified above has completed the requirements for the title indicated above (or that the required Certification was previously submitted) and that the information provided on this form is true and correct.

Signature: _____ Date: _____

Owner or Authorized Agent of Hound

OFFICIAL AMERICAN SIGHTHOUND FIELD ASSOCIATION
LCI ENTRY FORM
September 27, 2025

Early entries: \$20 per entry

Day of Trial entry: \$30 per entry

Early entries close Wed., September 24, 2025 Day of Trial entries close 8:00AM

Make Check payable in US funds to: MWCC

Mail entries to: Karen Breitbach, 1930 W Galena St, Milwaukee, WI 53205

Fee Paid _____ The Field Secretary cannot accept conditional, unsigned, incomplete or unpaid entries; please check your completed entry carefully.

Breed:	Call Name:	
Registered Name of dog:		
Stake: <input type="checkbox"/> LCI-Small <input type="checkbox"/> LCI-Large <input type="checkbox"/> LCI-Sighthound Mix <input type="checkbox"/> Open <input type="checkbox"/> Excellent <input type="checkbox"/> Veteran		
Registration Number: (please write in registering body before number)		
Date of Birth:	Sex: <input type="checkbox"/> Dog <input type="checkbox"/> Bitch	
Name of actual owner(s):		
Address:		Phone:
City:	State:	Zip:
E-mail	(Optional) Region of Residence:	
Emergency Contact Name and Phone (Optional)		
<input type="checkbox"/> Check if this is a first-time entry, a copy of the official Registration of this hound must accompany this entry. (i.e., AKC Registration form, PAL registration, Canine Partner, etc.)		
<input type="checkbox"/> Check if any information has changed since the last ASFA trial entry. Regarding _____		

I CERTIFY that I am the actual owner of this dog, or that I am the duly authorized agent of the actual owner whose name I have entered above. In consideration of the acceptance of this entry and the opportunity to have this dog judged and to win prize money, ribbons, or trophies, I (we) agree to abide by the rules and regulations of the American Sighthound Field Association in effect at the time of this lure field trial, and by any additional rules and regulations appearing in the premium list for this lure field trial. I (we) agree that the club holding this lure field trial has the right to refuse this entry for cause, which the club shall deem to be sufficient. I (we) agree to hold this club, its members, directors, governors, officers, agents or other functionaries, any employees of the aforementioned parties and the owner(s) of the trial premises or grounds harmless from any claim for loss or injury which may be alleged to have been caused directly or indirectly to any person or thing by the act of this dog while in or upon the lure field trial premises or grounds or near any entrance thereto and I (we) personally assume all responsibility and liability for any such claim, and I (we) further agree to hold the aforementioned parties harmless from any claim loss of this dog by disappearance, theft damage or injury be caused or alleged to be caused by the negligence of the club or any of the aforementioned parties or by the negligence of any person or any other cause or causes. I (we) certify and represent that the dog entered is not a hazard to person or other dogs. This entry is submitted for acceptance of the forgoing representations and agreements.

SIGNATURE of owner or his agent
duly authorized to make this entry _____

Please separate the entries before submitting to FTS.

OFFICIAL AMERICAN SIGHTHOUND FIELD ASSOCIATION
LCI ENTRY FORM
September 28, 2025

Early entries: \$20 per entry

Day of Trial entry: \$30 per entry

Early entries close Wed., September 24, 2025 Day of Trial entries close 8:00AM

Make Check payable in US funds to: MWCC

Mail entries to: Karen Breitbach, 1930 W Galena St, Milwaukee, WI 53205

Fee Paid _____ The Field Secretary cannot accept conditional, unsigned, incomplete or unpaid entries; please check your completed entry carefully.

Breed:	Call Name:	
Registered Name of dog:		
Stake: <input type="checkbox"/> LCI-Small <input type="checkbox"/> LCI-Large <input type="checkbox"/> LCI-Sighthound Mix <input type="checkbox"/> Open <input type="checkbox"/> Excellent <input type="checkbox"/> Veteran		
Registration Number: (please write in registering body before number)		
Date of Birth:	Sex: <input type="checkbox"/> Dog <input type="checkbox"/> Bitch	
Name of actual owner(s):		
Address:		Phone:
City:	State:	Zip:
E-mail	(Optional) Region of Residence:	
Emergency Contact Name and Phone (Optional)		
<input type="checkbox"/> Check if this is a first-time entry, a copy of the official Registration of this hound must accompany this entry. (i.e., AKC Registration form, PAL registration, Canine Partner, etc.)		
<input type="checkbox"/> Check if any information has changed since the last ASFA trial entry. Regarding _____		

I CERTIFY that I am the actual owner of this dog, or that I am the duly authorized agent of the actual owner whose name I have entered above. In consideration of the acceptance of this entry and the opportunity to have this dog judged and to win prize money, ribbons, or trophies, I (we) agree to abide by the rules and regulations of the American Sighthound Field Association in effect at the time of this lure field trial, and by any additional rules and regulations appearing in the premium list for this lure field trial. I (we) agree that the club holding this lure field trial has the right to refuse this entry for cause, which the club shall deem to be sufficient. I (we) agree to hold this club, its members, directors, governors, officers, agents or other functionaries, any employees of the aforementioned parties and the owner(s) of the trial premises or grounds harmless from any claim for loss or injury which may be alleged to have been caused directly or indirectly to any person or thing by the act of this dog while in or upon the lure field trial premises or grounds or near any entrance thereto and I (we) personally assume all responsibility and liability for any such claim, and I (we) further agree to hold the aforementioned parties harmless from any claim loss of this dog by disappearance, theft damage or injury be caused or alleged to be caused by the negligence of the club or any of the aforementioned parties or by the negligence of any person or any other cause or causes. I (we) certify and represent that the dog entered is not a hazard to person or other dogs. This entry is submitted for acceptance of the forgoing representations and agreements.

SIGNATURE of owner or his agent
duly authorized to make this entry _____

Please separate the entries before submitting to FTS.