

ROCKY MOUNTAIN COURSING CLUB

Darci Kunard
17531 E. 104th Place
Reunion, CO 80022
720-938-3303
kdarci@yahoo.com
www.asfa.org

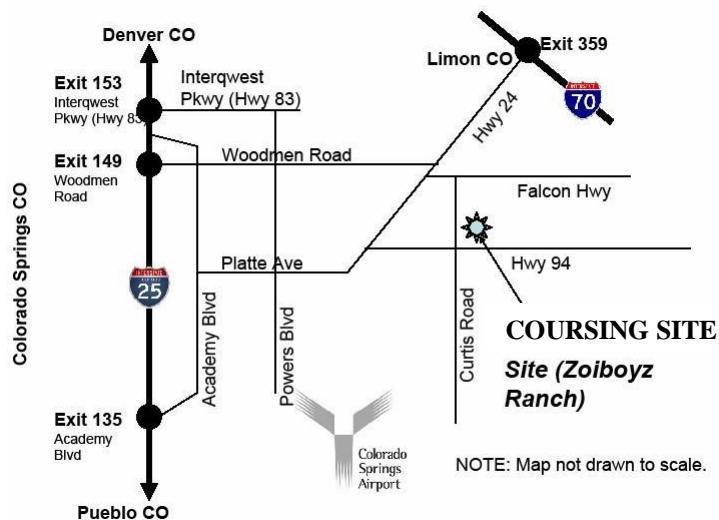

FROM THE SOUTH

1. From I-25 North, take exit 135 Academy Blvd
2. North on Academy 5.8 miles to East Platte Ave
3. Right on E. Platte 3.7 miles to Hwy 94 (direction Shriever AFB)
4. Right on Hwy 94 7.5 miles to Curtis Road (2nd light on Hwy 94)
5. Left on Curtis Road 1.9 miles to mailbox 2115 and Zoiboyz Ranch on right—it is the house surrounded by white fence on the hill. (Ignore the small house in front near Curtis Road. You've gone too far north on Curtis if you come to Falcon Hwy and a blinking red traffic signal.)

FROM THE NORTH

1. From I-25 South, take exit 153 Interquest Parkway/Hwy 83
2. Go on Hwy 83 to South Powers Blvd
3. Turn right on South Powers Blvd
4. Stay on Powers to Woodmen Road Exit
5. Go left (east) ~12 miles on Woodmen to its end at Hwy 24
6. Go right on Hwy 24 0.5 miles to Meridian
7. Go left on Meridian to STOP sign at Falcon Hwy
8. Turn left onto Falcon Hwy ~3 miles to flashing yellow (Curtis Rd)
9. Turn right (south) onto Curtis Road for 4.4 miles to mailbox 2115.
10. Turn left to Zoiboyz Ranch (NOTE: This will be the 2nd driveway on left after Davis Road. Ignore small house near Curtis Road; go on up the hill to the house surrounded by white fence. You've gone too far down Curtis if you come to Hwy 94 and a traffic signal)

FROM THE EAST

1. From I-70, take exit 359 (US Hwy 24) 54 miles to Falcon Hwy
2. Left (east) on Falcon Hwy 3.3 miles to Curtis Road
3. Right (south) on Curtis Road 4.4 miles to mailbox 2115.

4. Turn left to Zoiboyz Ranch (NOTE: This will be the 2nd driveway on left after Davis Road.

PREMIUM LIST

EARLY ENTRIES close on Wednesday, September 27, 2017 at the FTS's address.
DAY OF TRIAL ENTRIES close at 8:30 am the day of the trial at the FTS desk.

(Substitutions for lame hounds or bitches in season will be allowed prior to 8:30 A.M. on the day of the trial. Owner of the substituted hound must be the same as the hound already entered.)

REGION 3 ASFA ALL BREED LURE COURSING TRIAL



ROCKY MOUNTAIN COURSING CLUB

SATURDAY SEPTEMBER 30, 2017 SIGHTHOUNDS ONLY

Zoiboyz Ranch
2115 CURTIS ROAD
PEYTON, COLORADO 80831

ENTRY FEES: \$20.00 for first dog;
\$17.00 dog additional dog entered by same owner.
Day of trial entry: \$25.00

Mail official entries and payment to: Darci Kunard 17531 E. 104th Place,
Reunion, CO 80022. Please make checks payable to RMCC.

Go to: www.asfa.org for online Rulebook, Policies, Contacts, Club, Trial Schedules,
Trial Results and much more.

Permission has been granted by the American Sighthound Field Association for the holding
of this event under American Sighthound Field Association Rules and Regulations

Audrey Silverstein, Chairman
ASFA Scheduling Committee

ROCKY MOUNTAIN COURSING CLUB

OFFICERS AND DIRECTORS

President Janet Krick
Vice President Frank Cassano
Secretary Karen Ackerman
Treasurer Karen Ackerman

JUDGES (AND THEIR ASSIGNMENTS)

Frank Cassano, La Salle, CO
Tom Golcher, 2115 Curtis Rd, Peyton, CO 80831
Dan Heidel*, 10457 W. Hampden Ave. #102, Lakewood, CO 80227
S = Single Judge * = Provisional Judge # = Canadian Judge

SATURDAY 9/30/2017

JUDGE	A	Az	Ba	B	C	G	Ib	Iw	IG	P	R	S	SD	SI	SW	W	Sgl	Ltd
Frank		X	X	X			X		X		X		X	X		X	X	S
Tom	X	X	X		X	X	X	X	X	X	X	X	X	X	X	X		
Dan	X			X	*	*		X		X		*			*		X	

FIELD COMMITTEE

Field Chairman Janet Krick, 719-210-3898

Field Secretary Darci Kunard , 720-938-3303
17531 E. 104th Place, Reunion, CO 80022
kdarci@yahoo.com

Lure Operators R Buhrdorf, F Cassano, T Golcher, D Heidel

Any hound not present at Roll Call will be scratched and entry fee will not be refunded.

PayPal Instructions: Please scan your signed entries and email to kdarci@yahoo.com; this email address is the PayPal address. Please include \$2 per entry if paying by PayPal.

RIBBON PRIZES

Ribbons or rosettes will offered for all placements.

First=Blue, Second=Red, Third=Yellow, Fourth=White, NBQ=Green

Highest Scoring Single=Navy/Gold, Best of Breed=Purple/Gold

TRIAL HOURS: 8:00 a.m. until ribbons are awarded. Day of Trial Entries Close: 8:30am

ROLL CALL: PROMPTLY AT 9:00 A.M.

Any hound not present at Roll Call will be scratched and entry fee will not be refunded.

ELIGIBLE BREEDS & REGISTRY

Only purebred Afghan Hounds, Azawakhs, Basenjis, Borzoi, Cirneco dell'Etna, Greyhounds, Ibizan Hounds, Irish Wolfhounds, Italian Greyhounds, Pharaoh Hounds, Rhodesian Ridgebacks, Salukis, Scottish Deerhounds, Silken Windhound, Sloughis, and Whippets. Limited breeds may be entered in the Limited Stake or the Singles Stake. Limited breeds currently include purebred Chart Polski, Galgo Español, Magyar Agar, Peruvian Inca Orchid, Portuguese Podengo (Pequeno), Portuguese Podengo (Medio & Grande), and must be individually registered with the appropriate registry. All entries shall be individually registered with the AKC (including ILP & PAL), the NGA, the UKC, the FCI, an ASFA-recognized foreign or ASFA Board approved registry, or possess a CRN from the SPDBS. A photocopy of acceptable registry must be submitted with each hound's first ASFA field trial entry; this requirement is waived for hounds registered with the NGA.

ENTRIES WILL NOT BE ACKNOWLEDGED BY MAIL OR TELEPHONE. LATE, INCOMPLETE, UNSIGNED OR CONDITIONAL ENTRIES WILL NOT BE ACCEPTED.

REGULAR STAKES OFFERED:

OPEN - Any eligible sighthound, excluding ASFA Field Champions of record that has met ASFA Certification requirements.

FIELD CHAMPION - Any ASFA Field Champion

VETERAN - Any eligible sighthound which is 6 years or older on the day of the trial, except Irish Wolfhounds whose age shall be at least 5 years; and Afghans, Rhodesian Ridgebacks, Salukis and Whippets whose age shall be at least 7 years of age and has met ASFA certification requirements. Points go toward V-FCh and V-LCM titles.

SINGLE STAKE: Any eligible sighthound including those disqualified to run in other stakes. Each hound runs alone. Not eligible for Best of Breed or Best in Field. Hounds are eligible to earn TCP and CPX titles from the Singles stake. Limited breeds are not eligible for these titles.

LIMITED - Any eligible sighthound of an eligible Limited stake that has met certification requirements. Not eligible for Best of Breed or Best in field.

BEST IN FIELD WILL NOT BE OFFERED

GENERAL INFORMATION PLEASE READ CAREFULLY

ALL HANDLERS MUST BE PRESENT FOR ROLL CALL

INSPECTION AND ANNOUNCEMENTS

Any dog not present 5 minutes after roll call will be considered absent.

All dogs will be inspected prior to roll call

- The Zoiboyz property is being provided for the purposes of this trial. Please pickup after your dogs, respect property, and do not litter.
- There will be 1 port-o-pot on the field.
- Weather in Colorado is unpredictable – from very hot temperatures to snow – bring rain gear, layers of clothing, hat, gloves, sunglasses, and sunscreen. It is often windy – bring stakes for your shade cloths and canopies. There is NO shade on the field. Bring shade and lots of water for your dogs – there is NO hose or hookup for water available at the field site. Some first aid supplies will be available at the field; however, you should be advised to bring your own first aid kit for your dog.
- No fires allowed! If you must smoke, please do so inside of your vehicle; conditions are quite dry and even an errant cigarette ash could spark a fire.

FIELD AND EQUIPMENT INFORMATION

Terrain is mowed field grass with uneven ground. There is possibility of goatheads and cactus. Elevation of the course site is about 6800 feet and course layouts include up and downhill slopes. The perimeter of the property is fully fenced. **RMCC recommends that your hounds be in good physical condition before attempting the course.**

RMCC will use a battery-powered, continuous loop machine. The lure will consist of white plastic bags.

A \$20.00 fee will be assessed for any returned checks.

Persons exhibiting conduct detrimental to ASFA/RMCC/any dog(s)/other person(s) will be asked to leave the trial site AND appropriate disciplinary action will be filed– please conduct yourselves accordingly.

- ❏ Port-a-potty on site.
- ❏ BRING WATER AND SHADE FOR YOUR DOGS.
- ❏ Veterinarian - Saturday Black Forest Veterinary Clinic 719/495-3666. After hours Animal Emergency Care, 5520 North Nevada Ave., 719/260-7141.
- ❏ Due to dry conditions, smoking is prohibited on the field.
- ❏ Absolutely NO CAMP FIRES!
- ❏ PICK UP AFTER YOUR DOG AND YOURSELF!
- ❏ Please include a phone number on your entries in case of bad weather

COURSE PLAN:

Rocky Mountain Coursing Club reserves the right to alter the course design(s) depending on field and/or weather conditions on the day of the trial.

Saturday September 30, 2017

650 yards, clock wise for prelims and reversed for finals

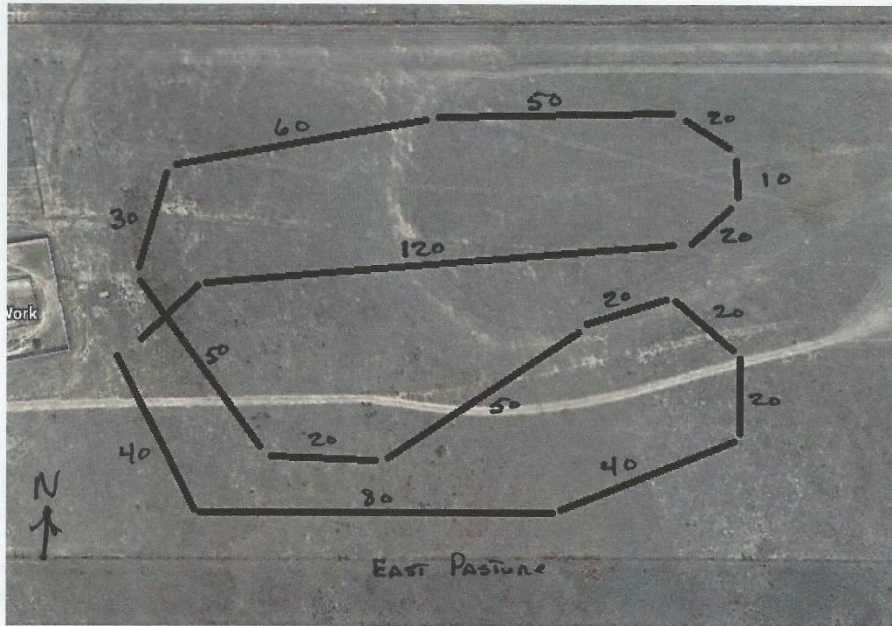

Warning: It is advised that all hounds entered be in top physical condition due to the altitude and rigorous conditions of the course, which will be run on natural terrain and may include such hazards as rocks, trees, cactus, vegetation, gopher holes, gullies, bodies of water and other obstacles. **ALL HOUNDS RUN AT THE OWNER'S SOLE RISK.**

Certifications and Practice Saturday, September 30, 2017

ASFA Certification held BEFORE the RMCC trial at 8:15 am.

Practices will be held AFTER the RMCC trial WEATHER AND MACHINERY PERMITTING

**All hounds will be inspected before running.
Lame hounds and bitches in season may NOT run.**

Certification: Any entry marked "First ASFA Point Trial" Must have an ASFA Hound Certification form and a copy of the hound's registration papers, not required for NGA greyhounds, and must present them to the Field Trial Secretary along with your entry before entering a regular ASFA trial. This applies to "First ASFA point trial" hounds entered in the OPEN, VETERAN or LIMITED stake. Certification forms will be available, but MUST be completed prior to judging. Also have your hound's registration number available for the Certification Form.

Certification: \$7.00, Owners wishing to certify a hound for competition are responsible for arranging a hound of the same breed, or similar running style, to run with his/her dog for the certification.

Practices: \$5.00 each dog

Plan on arriving to the field around 12:00pm; arrive earlier if you wish to see the competition. Practices and Certs will not be run earlier than 12:00pm, but may be held much later depending upon the entry in the trial.

Motels

The following will accept well behaved dogs, and are in the Colorado Springs area:
(Please verify with the hotel for current pet policies.)

Ramada Inn, I-25 & Hwy 24, Exit 145 – 719-633-5541

Howard Johnson, 8280 Hwy 83, Exit 150 – 719-598-6700

Super 8 Colorado Springs, 719-597-4100

Days Inn Colorado Springs, 719-266-1317

Motel 6, 3228 N. Chestnut – 719-520-5400

Falcon Meadow Campgrounds, 11150 Hwy 24, Falcon – 719-495-2694

(Falcon is 5 miles west of the trial site)

OFFICIAL AMERICAN SIGHTHOUND FIELD ASSOCIATION ENTRY FORM
ROCKY MOUNTAIN COURSING CLUB
SATURDAY SEPTEMBER 30, 2017
 ZOIBOYZ, 2115 Curtis Rd, Peyton, CO 80831
 EARLY ENTRIES CLOSE: Wednesday SEPTEMBER 27, 2017 at 6:00 P.M.
 \$20 first hound, \$17 each additional hound by same owner; \$25 day-of entry
 Make checks payable in US Funds Only to RMCC and mail with completed entry form to:
 Darci Kunard, 17531 E. 104th Place, Reunion, CO 80022

Fee Paid _____ The Field Secretary cannot accept conditional, unsigned, incomplete or unpaid entries; please check your completed entry carefully.

Breed:		Call Name:	
Registered Name of Hound:			
Stake: <input type="checkbox"/> Open <input type="checkbox"/> FCH <input type="checkbox"/> Veteran <input type="checkbox"/> Single <input type="checkbox"/> Limited		Additional Stakes <input type="checkbox"/> Kennel <input type="checkbox"/> Breeder <input type="checkbox"/> Bench	
Registration Number: (please write in registering body before number)			
<input type="checkbox"/> If possible, please separate my hounds		Date of Birth:	Sex: <input type="checkbox"/> Dog <input type="checkbox"/> Bitch
Name of actual owner(s):			
Address:		Phone:	
City:		State:	Zip:
E-mail (Optional)		(Optional) Region of Residence:	
Emergency Contact Name and Phone (Optional)			
<input type="checkbox"/> Check if this is the first ASFA trial for this hound. Attach a Hound Certification or waiver if entered in Open, Veterans, Limited.			
<input type="checkbox"/> Check if this is a first-time entry, a copy of the official Registration of this hound must accompany this entry unless NGA.			
<input type="checkbox"/> Check if any information has changed since the last ASFA trial entry. Regarding _____			
<input type="checkbox"/> Check if this hound has been dismissed within the last 6 trials entered. Must be marked in order to qualify for a "clean" trial requirement.			

I CERTIFY that I am the actual owner of this dog, or that I am the duly authorized agent of the actual owner whose name I have entered above. In consideration of the acceptance of this entry and the opportunity to have this dog judged and to win prize money, ribbons, or trophies, I (we) agree to abide by the rules and regulations of the American Sighthound Field Association in effect at the time of this lure field trial, and by any additional rules and regulations appearing in the premium list for this lure field trial. I (we) agree that the club holding this lure field trial has the right to refuse this entry for cause, which the club shall deem to be sufficient. I (we) agree to hold this club, its members, directors, governors, officers, agents or other functionaries, any employees of the aforementioned parties and the owner(s) of the trial premises or grounds harmless from any claim for loss or injury which may be alleged to have been caused directly or indirectly to any person or thing by the act of this dog while in or upon the lure field trial premises or grounds or near any entrance thereto and I (we) personally assume all responsibility and liability for any such claim, and I (we) further agree to hold the aforementioned parties harmless from any claim loss of this dog by disappearance, theft damage or injury be caused or alleged to be caused by the negligence of the club or any of the aforementioned parties or by the negligence of any person or any other cause or causes. I (we) certify and represent that the dog entered is not a hazard to person or other dogs. This entry is submitted for acceptance of the forgoing representations and agreements.

SIGNATURE of owner or his agent
 duly authorized to make this entry _____

Please separate the entries before submitting to FTS.

OFFICIAL AMERICAN SIGHTHOUND FIELD ASSOCIATION ENTRY FORM
ROCKY MOUNTAIN COURSING CLUB
SATURDAY SEPTEMBER 30, 2017
 ZOIBOYZ, 2115 Curtis Rd, Peyton, CO 80831
 EARLY ENTRIES CLOSE: Wednesday SEPTEMBER 27, 2017 at 6:00 P.M.
 \$20 first hound, \$17 each additional hound by same owner; \$25 day-of entry
 Make checks payable in US Funds Only to RMCC and mail with completed entry form to:
 Darci Kunard, 17531 E. 104th Place, Reunion, CO 80022

Fee Paid _____ The Field Secretary cannot accept conditional, unsigned, incomplete or unpaid entries; please check your completed entry carefully.

Breed:		Call Name:	
Registered Name of Hound:			
Stake: <input type="checkbox"/> Open <input type="checkbox"/> FCH <input type="checkbox"/> Veteran <input type="checkbox"/> Single <input type="checkbox"/> Limited		Additional Stakes <input type="checkbox"/> Kennel <input type="checkbox"/> Breeder <input type="checkbox"/> Bench	
Registration Number: (please write in registering body before number)			
<input type="checkbox"/> If possible, please separate my hounds		Date of Birth:	Sex: <input type="checkbox"/> Dog <input type="checkbox"/> Bitch
Name of actual owner(s):			
Address:		Phone:	
City:		State:	Zip:
E-mail (Optional)		(Optional) Region of Residence:	
Emergency Contact Name and Phone (Optional)			
<input type="checkbox"/> Check if this is the first ASFA trial for this hound. Attach a Hound Certification or waiver if entered in Open, Veterans, Limited.			
<input type="checkbox"/> Check if this is a first-time entry, a copy of the official Registration of this hound must accompany this entry unless NGA.			
<input type="checkbox"/> Check if any information has changed since the last ASFA trial entry. Regarding _____			
<input type="checkbox"/> Check if this hound has been dismissed within the last 6 trials entered. Must be marked in order to qualify for a "clean" trial requirement.			

I CERTIFY that I am the actual owner of this dog, or that I am the duly authorized agent of the actual owner whose name I have entered above. In consideration of the acceptance of this entry and the opportunity to have this dog judged and to win prize money, ribbons, or trophies, I (we) agree to abide by the rules and regulations of the American Sighthound Field Association in effect at the time of this lure field trial, and by any additional rules and regulations appearing in the premium list for this lure field trial. I (we) agree that the club holding this lure field trial has the right to refuse this entry for cause, which the club shall deem to be sufficient. I (we) agree to hold this club, its members, directors, governors, officers, agents or other functionaries, any employees of the aforementioned parties and the owner(s) of the trial premises or grounds harmless from any claim for loss or injury which may be alleged to have been caused directly or indirectly to any person or thing by the act of this dog while in or upon the lure field trial premises or grounds or near any entrance thereto and I (we) personally assume all responsibility and liability for any such claim, and I (we) further agree to hold the aforementioned parties harmless from any claim loss of this dog by disappearance, theft damage or injury be caused or alleged to be caused by the negligence of the club or any of the aforementioned parties or by the negligence of any person or any other cause or causes. I (we) certify and represent that the dog entered is not a hazard to person or other dogs. This entry is submitted for acceptance of the forgoing representations and agreements.

SIGNATURE of owner or his agent
 duly authorized to make this entry _____

Please separate the entries before submitting to FTS.

AMERICAN SIGHTHOUND FIELD ASSOCIATION

HOUD CERTIFICATION

Rule effective October 1, 1994: Ch. V, Sec. 4 (a) OPEN STAKE: *To be eligible to enter the open stake, a hound must have been certified by a licensed judge within the year preceding the closing date for the entry or have previously competed in the Open Stake.* This eligibility requirement also applies to a hound entered in the Limited or Veteran Stake, which has not competed in Open previously. Please complete this portion of this form and attach it to the entry form for the hound's first entry, including an entry for a Fun Trial.

Registered Name of Hound: _____

Registration Number: _____ Breed: _____

Registered Owner's Name: _____

I hereby certify that on (date) _____, the above named hound completed a lure course of at least 500 yards, running with another hound of the same breed (or another breed with a similar running style). During the course the above named hound showed no inclination to interfere with the other hound. I further certify that I am a licensed judge for the ASFA.

Name of Licensed Judge: _____

Signature: _____ Date: _____

I hereby certify that the hound running in the certification course is the hound identified above and that information provided on this form is true and correct.

Signature: _____ Date: _____

Owner or Authorized Agent of Hound

This certification form must be attached to the entry form the first time this hound is entered in an open, limited, or veteran stake. Any hound entered in open, limited, or veteran (as a first time entered hound), which has not been certified, shall be declared ineligible by the records coordinator and shall forfeit any points and placements awarded.

PLEASE RETAIN A COPY FOR YOUR RECORDS.

AMERICAN SIGHTHOUND FIELD ASSOCIATION

HOUD CERTIFICATION WAIVER

Waiver of Requirement: *This requirement will be waived for a hound that has earned a lure coursing or racing title from another recognized organization, if such title requires competition, and if a waiver for such title has been approved by the ASFA, or a CKC Hound Certification Form.* If your hound qualifies for a waiver, complete this portion of this form and attach it to your entry form. Proof of waivers must accompany this certification form.

Registered Name of Hound: _____

Registration Number: _____ Breed: _____

Registered Owner's Name: _____

CKC:	FCH	FCHX		CWA:	ARX	TRP	SRA	
	DPC							
AKC:	QC	SC	FC	LGRA:	GRC	NAWRA:	RCH	SR
WRA:	CR	WRCH		NOTRA:	ORC	OTR	SORC	
	SOR							

Hound Certification previously submitted.

I hereby certify that the hound identified above has completed the requirements for the title indicated above (or that the required Certification was previously submitted) and that the information provided on this form is true and correct.

Signature: _____ Date: _____

Owner or Authorized Agent of Hound

AMERICAN SIGHTHOUND FIELD ASSOCIATION

HOUD CERTIFICATION

Rule effective October 1, 1994: Ch. V, Sec. 4 (a) OPEN STAKE: *To be eligible to enter the open stake, a hound must have been certified by a licensed judge within the year preceding the closing date for the entry or have previously competed in the Open Stake.* This eligibility requirement also applies to a hound entered in the Limited or Veteran Stake, which has not competed in Open previously. Please complete this portion of this form and attach it to the entry form for the hound's first entry, including an entry for a Fun Trial.

Registered Name of Hound: _____

Registration Number: _____ Breed: _____

Registered Owner's Name: _____

I hereby certify that on (date) _____, the above named hound completed a lure course of at least 500 yards, running with another hound of the same breed (or another breed with a similar running style). During the course the above named hound showed no inclination to interfere with the other hound. I further certify that I am a licensed judge for the ASFA.

Name of Licensed Judge: _____

Signature: _____ Date: _____

I hereby certify that the hound running in the certification course is the hound identified above and that information provided on this form is true and correct.

Signature: _____ Date: _____

Owner or Authorized Agent of Hound

This certification form must be attached to the entry form the first time this hound is entered in an open, limited, or veteran stake. Any hound entered in open, limited, or veteran (as a first time entered hound), which has not been certified, shall be declared ineligible by the records coordinator and shall forfeit any points and placements awarded.

PLEASE RETAIN A COPY FOR YOUR RECORDS.

AMERICAN SIGHTHOUND FIELD ASSOCIATION

HOUD CERTIFICATION WAIVER

Waiver of Requirement: *This requirement will be waived for a hound that has earned a lure coursing or racing title from another recognized organization, if such title requires competition, and if a waiver for such title has been approved by the ASFA, or a CKC Hound Certification Form.* If your hound qualifies for a waiver, complete this portion of this form and attach it to your entry form. Proof of waivers must accompany this certification form.

Registered Name of Hound: _____

Registration Number: _____ Breed: _____

Registered Owner's Name: _____

CKC:	FCH	FCHX		CWA:	ARX	TRP	SRA	
	DPC							
AKC:	QC	SC	FC	LGRA:	GRC	NAWRA:	RCH	SR
WRA:	CR	WRCH		NOTRA:	ORC	OTR	SORC	
	SOR							

Hound Certification previously submitted.

I hereby certify that the hound identified above has completed the requirements for the title indicated above (or that the required Certification was previously submitted) and that the information provided on this form is true and correct.

Signature: _____ Date: _____

Owner or Authorized Agent of Hound