

# PREMIUM LIST

ENTRIES CLOSE **Wednesday September 19** at the FTS's address



**MIDWEST COURSING CLUB**

## ASFA ALL-BREED REGION 6 INVITATIONAL

**Saturday September 29, 2018**

Greater Racine Kennel Club  
Caledonia, WI

(15 miles south of Milwaukee, WI off of I - 94)

**Entry Fee: \$25 per Hound**

**\$5 each for Bench, Kennel and Breeder Stakes**

Regional Invitational Requirements

**Eligibility.** Any hound that is ASFA pointed, or is pointed in its country of residence, or is AKC pointed, is eligible to enter a Regional Invitational in an appropriate stake, including Single Stake, if offered. Proof of non-ASFA points for hounds should be in the form of a photocopy of the certificate, or a page of formal printing, included with the entry. For a Limited breed to be eligible, the entry must have one first placement, or two second placements, with competition in the Limited Stake. For a Provisional breed to be eligible, the hound must have received a placement with competition. All points or placements must be earned by the closing date of the event. An eligible hound may be entered in any number of Regional Invitationals. Hounds entered in the Single Stake are not eligible to be entered in Breeder, Kennel, or Bench stakes

Permission has been granted by the American Sighthound Field Association for this event under American Sighthound Field Association Rules and Regulations.

Audrey Silverstein, Chair  
ASFA Scheduling Committee

Go to [www.ASFA.org](http://www.ASFA.org) for online Rulebook, Policies, Contacts, Clubs, Trial Schedules, Trial Results & much more.

### Midwest Coursing Club

**Club Officers** President: Tara Ragatz, Vice-President: Ron Horner, Secretary: Ann Montez, Treasurer: Greg Breitbach Board of Directors: : Frank Humpal, Chris Bernstein, Brigid Boyle, Clayton Montez

**ASFA Officers, Board, Regional Directors Pres:** Dean Wright; **1st VP:** Phil Fullam; **2nd VP:** Gregory Breitbach; **Corr. Sec'y:** Holly Hamiltont; **Rec. Sec'y:** Ping Pirrung; **Chief Financial Officer:** Gary Roush  
**Region 1 Dir:** Karen Sanders **Region 2 Dir** open **Region 3 Dir:** Dan Heidel **Region 4 Dir:** Gary Runyan **Region 5 Dir:** Kent Standeford **Region 6 Dir:** Lee Warden **Region 7 Dir:** Elaine McMichael  
**Region 8 Dir:** Kathy Sanders **Region 9 Dir:** Ben Brodeur **Region 10 Dir:** Lori Silvestri

### JUDGES & ASSIGNMENTS

Gregory Breitbach, Milwaukee, WI

Kevin Carlson, Racine, WI

Katie Kaltenborn, Cynthiana, KY

Lee Warden, Ortonville, MI

	A	Az	Ba	B	C	G	Ib	IG	IW	Ltd	P	RR	S	SD	SL	SW	SI	W
Gregory Breitbach	X	X			X	X				X								
Kevin Carlson	X	X			X	X				X								
Katie Kaltenborn			X	X			X	X	X		X	X	X	X	X	X	X	X
Lee Warden			X	X			X	X	X		X	X	X	X	X	X	X	X
Running Order	P	Ba	B	Ib	IG	IW	RR	S	SD	SL	SW	SI	W	A	Az	C	Ltd	G

### FIELD COMMITTEE

Field Trial Chairman	<b>Gregory Breitbach</b>
Field Trial Secretary	<b>Karen Breitbach</b>
Lure Operators	<b>Gregory Breitbach, Kevin Carlson, Frank Humpal, Clay Montez, Jonathan Ragatz</b>

TRIAL HOURS 6:00 AM CDT UNTIL AFTER RIBBONS ARE AWARDED.

**Day Substitutions (same owner) until 7:00 AM CDT Day of Trial**

**ROLL CALL: PROMPTLY at 7:30 AM CDT**

**(Earlier for Field Committee)**

Karen Breitbach - FTS

**1930 W Galena St, Milwaukee, WI 53205**

**4143442276 • foolishoun@att.net**

**midwestcoursing.homestead.com**

ENTRIES WILL NOT BE ACKNOWLEDGED BY RETURN MAIL OR PHONE;  
ENTRIES MAY BE ACKNOWLEDGED BY E-MAIL  
IF OWNER FORWARDS E-MAIL ADDRESS.

**ASFA Regional Rosettes will offered for all placements**  
**First=Blue, Second=Red, Third=Yellow, Fourth=White, NBQ=Green**  
**High Score Single=Navy/Gold, Best of Breed=Purple/Gold,**  
**& Best in Field=Red, White & Blue.**

Bench, Kennel, and Breeder: pink/green

**ASFA Medallions are awarded to each Best of Breed Winner**

**Other prizes may be offered by MWCC and Friends of MWCC**

### ELIGIBLE BREEDS & REGISTRY

Only purebred Afghan Hounds, Azawakhs, Basenjis, Borzoi, Cirneco dell'Etna, Greyhounds, Ibizan Hounds, Irish Wolfhounds, Italian Greyhounds, Pharaoh Hounds, Rhodesian Ridgebacks, Salukis, Scottish Deerhounds, Silken Windhounds, Sloughis, Whippets, and Provisional breeds may be entered in the regular stakes. Current Provisional breed: None.

Limited breeds may be entered in the Limited Stake or the Singles Stake. Limited breeds currently include purebred Chart Polski, Galgo Español, Magyar Agar, Peruvian Inca Orchid, Portuguese Podengo (Pequeno), Portuguese Podengo (Medio & Grande), and must be individually registered with the appropriate registry.

All entries shall be individually registered with the AKC (ILP/PAL included), the NGA, the UKC, the FCI, an ASFA-recognized foreign or ASFA Board approved registry, or possess a CRN from the SPDBS. A photocopy of acceptable registry must be submitted with each hound's first ASFA field trial entry; this requirement is waived for hounds registered with the NGA.

### REGULAR STAKES OFFERED

**OPEN STAKE:** Any eligible sighthound, excluding ASFA Field Champions of record.

**FIELD CHAMPION STAKE:** Any ASFA Field Champion

**VETERAN STAKE:** Any eligible hound whose age is at least six years, except Irish Wolfhounds whose age shall be at least five years, and Afghan Hounds, Rhodesian Ridgebacks, Salukis and Whippets whose age shall be at least seven years. Points go toward V-FCh or V-LCM titles.

**LIMITED STAKE:** Any eligible sighthound of a Limited breed that has met certification requirements. Not eligible to compete in Best of Breed or Best in Field.

**SINGLE STAKE:** Any eligible sighthound including those disqualified to run in other stakes. Each hound runs alone. Not eligible for Best of Breed or Best in Field. Hounds are eligible to earn TCP and CPX titles from the Singles stake. Limited breeds are not eligible for these titles.

### NON-REGULAR STAKES OFFERED

**KENNEL STAKE:** For hounds of any individual breeds; an entry shall consist of two hounds, designated at time of entry, in one of the regular stakes being owned and kenneled by the same person.

**BREEDER STAKE:** For any breed which shall have, designated at time of entry, two hounds bred by the same individual.

**BENCH STAKE:** For any eligible sighthound with proof on file with the ASFA of a conformation champion title from the AKC, CKC or both, or a conformation grand champion title from the UKC.

### **BEST IN FIELD WILL BE OFFERED**

**Conditions of Entry:** All entries must be one year or older on the day of the trial ● Stakes will be split into flights by public random draw if the entry in any regular stake is 20 or more ● Bitches in season, lame hounds and hounds with breed disqualifications will be excused at roll call. Spayed, neutered, monorchid or cryptorchid hounds without breed disqualifications may be entered; hounds with breed disqualifications are not eligible to enter except in the Single Stake ● Hounds not present at the time of roll call will be scratched ● All hounds will run twice, in trios if possible or braces (except in the Single Stake), unless excused, dismissed or disqualified.

**Equipment:** Type of lure machine: Gas powered continuous-loop system. ● Type of lures: highly-visible white plastic strips ● Back-up equipment will be available.

**PayPal for Early Entries accepted! Go to [www.midwestcoursing.homestead.com](http://www.midwestcoursing.homestead.com) to make payment**

### **IMPORTANT Early Entry PAYPAL RULES!!!!**

**YOU MUST** Email the FTS the following entry information at foolishoun@att.net no later than 3:00 pm September 19, 2018:

\*Breed,

\*Call Name

\*Registration Number

\*Owners Name and Address

\*Stake(s) Entered

\*Days Entered

\*Your Name and Phone Number.

Failure to do this will result in **DAY OF TRIAL FEES!!!!**

**YOU MUST** bring the **HARD COPY** Entry Form for each entry each day to the Trial. **ASFA requirement.**

MWCC adds \$2 to each PayPal entry to cover PayPal fees.

Late, incomplete, unsigned, or UNPAID entries will NOT be accepted.

Make check payable to "**MWCC**".

Substitutes for lame or in-season hounds are allowed if substitute has same owner and the Field Secretary is notified by 8:00 AM the day of the trial.

## COURSE PLANS

Course will be reversed for finals and again for run-offs and Best of Breed.

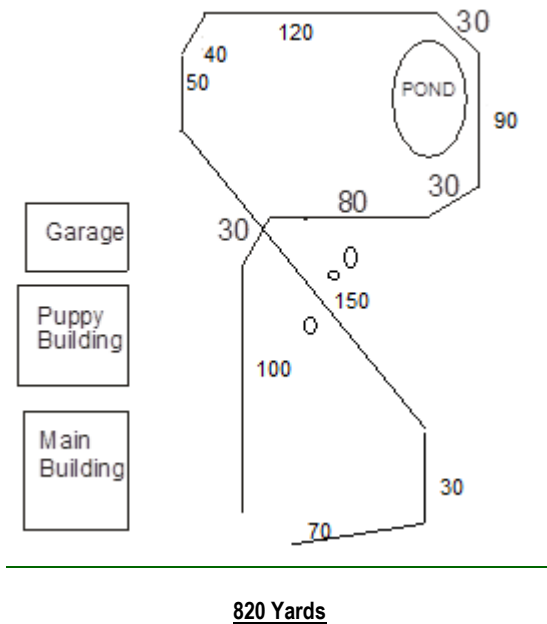

## OTHER INFORMATION

### **MOTELS AND CAMPGROUNDS**

**Value Inn, Oak Creek, WI,** 9420 S 20th St, (off I -94 and Ryan Road), 414-761-3807

**Red Roof Inn:** 6360 S 13th St, Oak Creek, WI, Phone:1-800-733-7663

**LaQuinta Inn Airport:** 7141 South 13th St, Oak Creek, WI 53154

Phone: 1-414-762-2266

**LaQuinta Inn:** 7540 118th Ave, Pleasant Prairie, WI 53158 Phone: 1-262-857-7911

**Red Roof Inn Milwaukee Airport:** 6360 South 13TH Street Oak Creek, WI 53154 414-764-350

**Super 8:** 1150 Oakes Rd, Racine, WI 262-884-0486

**Cliffside County Park Campgrounds:** 7320 Michna Rd, Racine, WI 262-639-3385

**Jellystone Park Camping Resort:** 8425 Hwy 38 Caledonia, WI 262-835-2565

**There is no camping allowed on the trial site due to city ordinance.**

**Conditions change, verify with hotel about pet accommodations.**

### *Site and Directions*

The Greater Racine Kennel Club grounds are not fenced but are set well off the road with natural boundaries of trees and tall grass. Well water is available. Bring your own shade.

**Address is 6320 Hwy G, Caledonia, WI**

**GPS coordinates:N42.81486 W087.85709**

The Kennel Club is 15 miles south of Milwaukee.

Exit I-94 at Hwy G and go East on G. It will wind and become six mile road.

The Kennel Club is on the north side of the road with a wooden "GRKC" at the end of the driveway. Follow trial signs.

**BREAKFAST AND LUNCH** will be available for a nominal fee.

No alcoholic beverages allowed on the site.

**Cell phone number at the field the day of the trial: 414-702-2276**

### **VETERINARIAN ON CALL**

Green Bay Road Animal Emergency

4333 S. Green Bay Road

Racine, WI 262-553-9223

**OR**

WI Veterinary Referral Center

OPEN 24 hours Emergency Service

360 Bluemound Road, Waukesha, WI

262- 542- 3241

# Region 6 Invitational Perpetual Trophies

*All perpetual trophies won in 2017 must be returned to the 2018 Region 6 Invitational Trial Chair by 7:30 am Sep 29, 2018.*

## **Irish Wolfhound — The Brynmair Trophy**

The Brynmair Trophy, donated by the hounds of Brynmair, is in honor of the coursing Irish Wolfhounds past and present and to encourage the continued participation of those hounds who love the sport of lure coursing.

## **Rhodesian Ridgeback — The Old Goat Trophy**

Donated in loving memory of EVE, Ch Windriver's Crimson Arrow CD LCM CGC ROM VC. The foundation of Rare Earth Ridgebacks. Eve's claim to fame is more for her descendants than from her own coursing career, which didn't start until she was six years old. Eve earned her LCM at the age of ten and was still used as test dog at fourteen. Eve's descendants include four #1 RRs: Phoebe, Maggie Mae, Ida and Wanda as well as seven Lifetime Top Twenty RRs: Ida, Star, Zappa, Troi, Tango, Wanda and Nitro. Eve's love for coursing was distinguished by her signature chortle before the Tally-Ho and her passion to shred the bunnies...two traits that seem to be inherited by her offspring!

## **Saluki — The Saluki Trophy**

Donated by Tom Cigolle Jr in loving memory of BIT Montebello Sherom's Fuhais LCM6. Fuhais' wish was to make sure that the Salukis of today and tomorrow are always honored and remembered. Her passion for the chase is the legacy she leaves to us all.

## **Whippet — The Bevis Trophy**

The Bevis Trophy was originally called The S.L.O. (Sharon Louise Othick) Trophy, but was later renamed to honor "Air Bevis", as he was known in the Othick household. FC TnT's My Foolish Heart, LCM7, LCX was ASFA's highest scoring whippet in 1998, was #4 in 1999 and #11 in 2000. Bevis had enthusiasm and flash on the field and always gave 110%, but was also a great hound at home and returned the love he received ten-fold.

## **Best in Regional — The Director's Cup**

Donated by Mike Scanlan to honor the Best In Regional Invitational winner, past, present, and future.

- All hounds will run twice, in trios if possible or braces (except in the Single Stake), unless excused, dismissed or disqualified.
- Muzzles are not required. It is the responsibility of the owner to determine if their hound needs to be muzzled.
- There will be a \$5 fine for any loose hound on the field that is not part of the course in progress.
- There will be a \$31 fee assessed for any returned checks
- **MWCC assumes no liability for injury to any hound or person, before, during or after the trial.**

**OFFICIAL AMERICAN SIGHTHOUND FIELD ASSOCIATION ENTRY FORM**

**Region 6 Invitational  
Saturday, September 29, 2018**

Entries: \$25 each hound No Day of Trial entry

Entries close Wed., Sep 19, 2018

Make Check payable in US funds to: MWCC

Mail entries to: Karen Breitbart, 1930 W Galena St, Milwaukee, WI 53205

Fee Paid \_\_\_\_\_ The Field Secretary cannot accept conditional, unsigned, incomplete or unpaid entries; please check your completed entry carefully.

Breed:		Call Name:	
Registered Name of Hound:			
Stake: <input type="checkbox"/> Open <input type="checkbox"/> FCH <input type="checkbox"/> Veteran <input type="checkbox"/> Single <input type="checkbox"/> Limited		Additional Stakes <input type="checkbox"/> Kennel <input type="checkbox"/> Breeder <input type="checkbox"/> Bench	
<b>Registration Number:</b> (please write in registering body before number)			
<input type="checkbox"/> If possible, please separate my hounds	Date of Birth:	Sex: <input type="checkbox"/> Dog <input type="checkbox"/> Bitch	
Name of actual owner(s):			
Address:		Phone:	
City:	State:	Zip:	
E-mail (Optional)		(Optional) Region of Residence:	
Emergency Contact Name and Phone (Optional)			
<input type="checkbox"/> <b>Check if this is the first ASFA trial for this hound. Attach a Hound Certification or waiver if entered in Open, Veterans, Limited.</b>			
<input type="checkbox"/> <b>Check if this is a first-time entry, a copy of the official Registration of this hound must accompany this entry unless NGA.</b>			
<input type="checkbox"/> Check if any information has changed since the last ASFA trial entry. Regarding _____			
<input type="checkbox"/> Check if this hound has been dismissed within the last 6 trials entered. Must be marked in order to qualify for a "clean" trial requirement.			

I CERTIFY that I am the actual owner of this dog, or that I am the duly authorized agent of the actual owner whose name I have entered above. In consideration of the acceptance of this entry and the opportunity to have this dog judged and to win prize money, ribbons, or trophies, I (we) agree to abide by the rules and regulations of the American Sighthound Field Association in effect at the time of this lure field trial, and by any additional rules and regulations appearing in the premium list for this lure field trial. I (we) agree that the club holding this lure field trial has the right to refuse this entry for cause, which the club shall deem to be sufficient. I (we) agree to hold this club, its members, directors, governors, officers, agents or other functionaries, any employees of the aforementioned parties and the owner(s) of the trial premises or grounds harmless from any claim for loss or injury which may be alleged to have been caused directly or indirectly to any person or thing by the act of this dog while in or upon the lure field trial premises or grounds or near any entrance thereto and I (we) personally assume all responsibility and liability for any such claim, and I (we) further agree to hold the aforementioned parties harmless from any claim loss of this dog by disappearance, theft damage or injury be caused or alleged to be caused by the negligence of the club or any of the aforementioned parties or by the negligence of any person or any other cause or causes. I (we) certify and represent that the dog entered is not a hazard to person or other dogs. This entry is submitted for acceptance of the forgoing representations and agreements.

**SIGNATURE** of owner or his agent  
duly authorized to make this entry \_\_\_\_\_

**Please separate the entries before submitting to FTS**

**OFFICIAL AMERICAN SIGHTHOUND FIELD ASSOCIATION ENTRY FORM**

**Region 6 Invitational  
Saturday, September 29, 2018**

Entries: \$25 each hound No Day of Trial entry

Entries close Wed., Sep 19, 2018

Make Check payable in US funds to: MWCC

Mail entries to: Karen Breitbart, 1930 W Galena St, Milwaukee, WI 53205

Fee Paid \_\_\_\_\_ The Field Secretary cannot accept conditional, unsigned, incomplete or unpaid entries; please check your completed entry carefully.

Breed:		Call Name:	
Registered Name of Hound:			
Stake: <input type="checkbox"/> Open <input type="checkbox"/> FCH <input type="checkbox"/> Veteran <input type="checkbox"/> Single <input type="checkbox"/> Limited		Additional Stakes <input type="checkbox"/> Kennel <input type="checkbox"/> Breeder <input type="checkbox"/> Bench	
<b>Registration Number:</b> (please write in registering body before number)			
<input type="checkbox"/> If possible, please separate my hounds	Date of Birth:	Sex: <input type="checkbox"/> Dog <input type="checkbox"/> Bitch	
Name of actual owner(s):			
Address:		Phone:	
City:	State:	Zip:	
E-mail (Optional)		(Optional) Region of Residence:	
Emergency Contact Name and Phone (Optional)			
<input type="checkbox"/> <b>Check if this is the first ASFA trial for this hound. Attach a Hound Certification or waiver if entered in Open, Veterans, Limited.</b>			
<input type="checkbox"/> <b>Check if this is a first-time entry, a copy of the official Registration of this hound must accompany this entry unless NGA.</b>			
<input type="checkbox"/> Check if any information has changed since the last ASFA trial entry. Regarding _____			
<input type="checkbox"/> Check if this hound has been dismissed within the last 6 trials entered. Must be marked in order to qualify for a "clean" trial requirement.			

I CERTIFY that I am the actual owner of this dog, or that I am the duly authorized agent of the actual owner whose name I have entered above. In consideration of the acceptance of this entry and the opportunity to have this dog judged and to win prize money, ribbons, or trophies, I (we) agree to abide by the rules and regulations of the American Sighthound Field Association in effect at the time of this lure field trial, and by any additional rules and regulations appearing in the premium list for this lure field trial. I (we) agree that the club holding this lure field trial has the right to refuse this entry for cause, which the club shall deem to be sufficient. I (we) agree to hold this club, its members, directors, governors, officers, agents or other functionaries, any employees of the aforementioned parties and the owner(s) of the trial premises or grounds harmless from any claim for loss or injury which may be alleged to have been caused directly or indirectly to any person or thing by the act of this dog while in or upon the lure field trial premises or grounds or near any entrance thereto and I (we) personally assume all responsibility and liability for any such claim, and I (we) further agree to hold the aforementioned parties harmless from any claim loss of this dog by disappearance, theft damage or injury be caused or alleged to be caused by the negligence of the club or any of the aforementioned parties or by the negligence of any person or any other cause or causes. I (we) certify and represent that the dog entered is not a hazard to person or other dogs. This entry is submitted for acceptance of the forgoing representations and agreements.

**SIGNATURE** of owner or his agent  
duly authorized to make this entry \_\_\_\_\_

**Please separate the entries before submitting to FTS**

**AMERICAN SIGHTHOUND FIELD ASSOCIATION  
HOUND CERTIFICATION**

**Rule effective October 1, 1994: Ch. V, Sec. 4 (a) OPEN STAKE:** *To be eligible to enter the open stake, a hound must have been certified by a licensed judge within the year preceding the closing date for the entry or have previously competed in the Open Stake.* This eligibility requirement also applies to a hound entered in the Limited or Veteran Stake, which has not competed in Open previously. Please complete this portion of this form and attach it to the entry form for the hound's first entry, including an entry for a Fun Trial.

Registered Name of Hound: \_\_\_\_\_

Registration Number: \_\_\_\_\_ Breed: \_\_\_\_\_

Registered Owner's Name: \_\_\_\_\_

I hereby certify that on (date) \_\_\_\_\_, the above named hound completed a lure course of at least 500 yards, running with another hound of the same breed (or another breed with a similar running style). During the course the above named hound showed no inclination to interfere with the other hound. I further certify that I am a licensed judge for the ASFA.

Name of Licensed Judge: \_\_\_\_\_

Signature: \_\_\_\_\_ Date: \_\_\_\_\_

I hereby certify that the hound running in the certification course is the hound identified above and that information provided on this form is true and correct.

Signature: \_\_\_\_\_ Date: \_\_\_\_\_

Owner or Authorized Agent of Hound

This certification form must be attached to the entry form the first time this hound is entered in an open, limited, or veteran stake. Any hound entered in open, limited, or veteran (as a first time entered hound), which has not been certified, shall be declared ineligible by the records coordinator and shall forfeit any points and placements awarded.

**PLEASE RETAIN A COPY FOR YOUR RECORDS.**

**AMERICAN SIGHTHOUND FIELD ASSOCIATION  
HOUND CERTIFICATION WAIVER**

**Waiver of Requirement:** *This requirement will be waived for a hound that has earned a lure coursing or racing title from another recognized organization, if such title requires competition, and if a waiver for such title has been approved by the ASFA, or a CKC Hound Certification Form.* If your hound qualifies for a waiver, complete this portion of this form and attach it to your entry form. Proof of waivers must accompany this certification form.

Registered Name of Hound: \_\_\_\_\_

Registration Number: \_\_\_\_\_ Breed: \_\_\_\_\_

Registered Owner's Name: \_\_\_\_\_

<b>CKC:</b>	FCH	FCHX	<b>CWA:</b>	ARX	TRP	SRA	DPC	
<b>AKC:</b>	QC	SC	FC	<b>LGRA:</b>	GRC	<b>NAWRA:</b>	RCH	SR
<b>WRA:</b>	CR	WRCH	<b>NOTRA:</b>	ORC	OTR	SORC	SOR	

Hound Certification previously submitted.

I hereby certify that the hound identified above has completed the requirements for the title indicated above (or that the required Certification was previously submitted) and that the information provided on this form is true and correct.

Signature: \_\_\_\_\_ Date: \_\_\_\_\_

Owner or Authorized Agent of Hound

**AMERICAN SIGHTHOUND FIELD ASSOCIATION  
HOUND CERTIFICATION**

**Rule effective October 1, 1994: Ch. V, Sec. 4 (a) OPEN STAKE:** *To be eligible to enter the open stake, a hound must have been certified by a licensed judge within the year preceding the closing date for the entry or have previously competed in the Open Stake.* This eligibility requirement also applies to a hound entered in the Limited or Veteran Stake, which has not competed in Open previously. Please complete this portion of this form and attach it to the entry form for the hound's first entry, including an entry for a Fun Trial.

Registered Name of Hound: \_\_\_\_\_

Registration Number: \_\_\_\_\_ Breed: \_\_\_\_\_

Registered Owner's Name: \_\_\_\_\_

I hereby certify that on (date) \_\_\_\_\_, the above named hound completed a lure course of at least 500 yards, running with another hound of the same breed (or another breed with a similar running style). During the course the above named hound showed no inclination to interfere with the other hound. I further certify that I am a licensed judge for the ASFA.

Name of Licensed Judge: \_\_\_\_\_

Signature: \_\_\_\_\_ Date: \_\_\_\_\_

I hereby certify that the hound running in the certification course is the hound identified above and that information provided on this form is true and correct.

Signature: \_\_\_\_\_ Date: \_\_\_\_\_

Owner or Authorized Agent of Hound

This certification form must be attached to the entry form the first time this hound is entered in an open, limited, or veteran stake. Any hound entered in open, limited, or veteran (as a first time entered hound), which has not been certified, shall be declared ineligible by the records coordinator and shall forfeit any points and placements awarded.

**PLEASE RETAIN A COPY FOR YOUR RECORDS.**

**AMERICAN SIGHTHOUND FIELD ASSOCIATION  
HOUND CERTIFICATION WAIVER**

**Waiver of Requirement:** *This requirement will be waived for a hound that has earned a lure coursing or racing title from another recognized organization, if such title requires competition, and if a waiver for such title has been approved by the ASFA, or a CKC Hound Certification Form.* If your hound qualifies for a waiver, complete this portion of this form and attach it to your entry form. Proof of waivers must accompany this certification form.

Registered Name of Hound: \_\_\_\_\_

Registration Number: \_\_\_\_\_ Breed: \_\_\_\_\_

Registered Owner's Name: \_\_\_\_\_

<b>CKC:</b>	FCH	FCHX	<b>CWA:</b>	ARX	TRP	SRA	DPC	
<b>AKC:</b>	QC	SC	FC	<b>LGRA:</b>	GRC	<b>NAWRA:</b>	RCH	SR
<b>WRA:</b>	CR	WRCH	<b>NOTRA:</b>	ORC	OTR	SORC	SOR	

Hound Certification previously submitted.

I hereby certify that the hound identified above has completed the requirements for the title indicated above (or that the required Certification was previously submitted) and that the information provided on this form is true and correct.

Signature: \_\_\_\_\_ Date: \_\_\_\_\_

Owner or Authorized Agent of Hound